

Myths, Lies, and Truths about the Linux kernel

Greg Kroah-Hartman
SuSE Labs / Novell



**“My favorite nemesis –
plug & play – is still not at
Window's level.”**



**“My favorite nemesis –
plug & play – is still not at
Window's level.”**

**- Jeff Jaffe
CTO Novell Inc.**



**“My favorite nemesis –
plug & play – is still not at
Window's level.”**

**- Jeff Jaffe
CTO Novell Inc.**

April 3, 2006

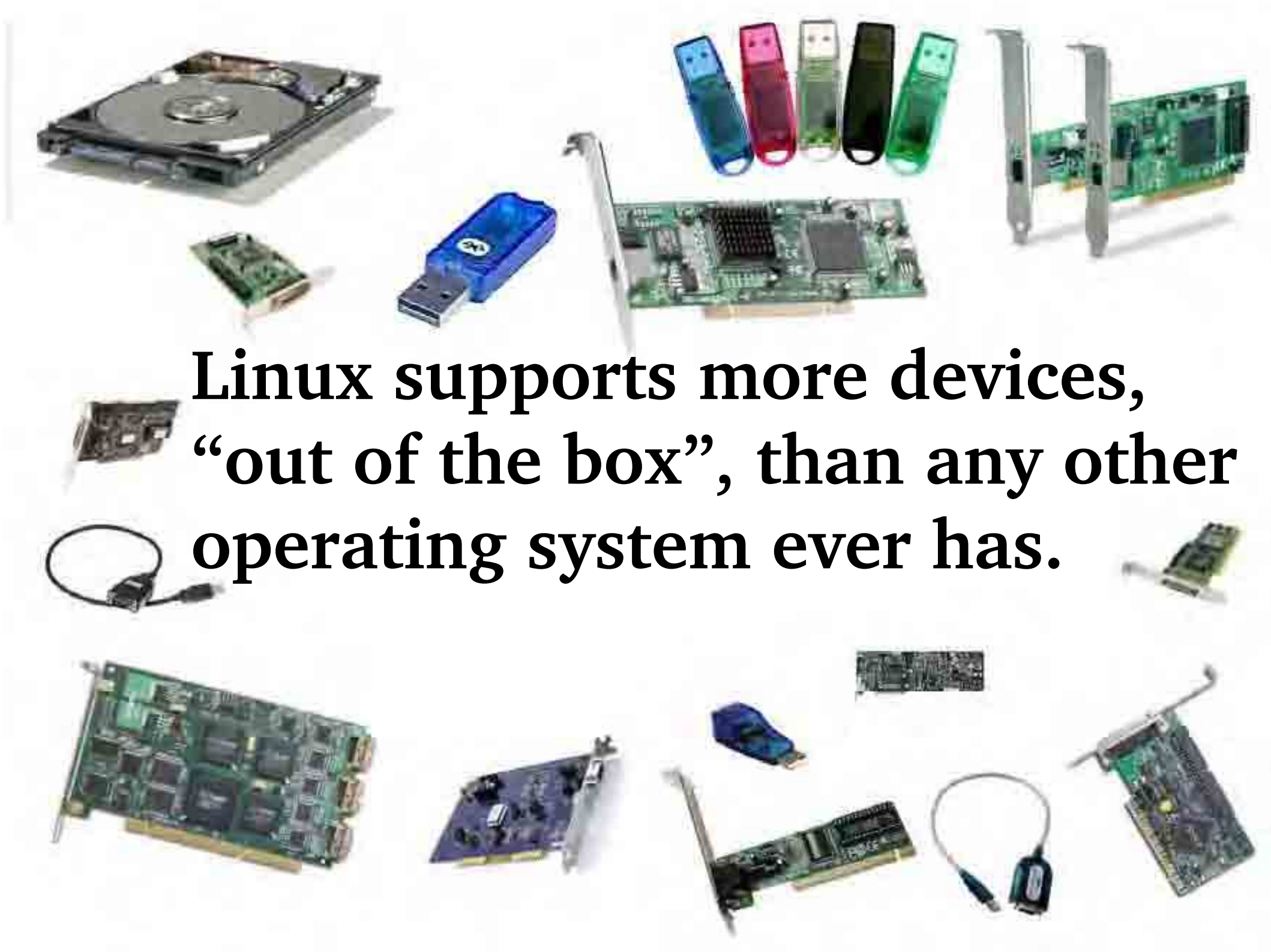
A collage of various computer hardware components including hard drives, USB drives, network cards, and cables. The items are scattered around the central text, illustrating the wide range of devices supported by Linux.

**Linux supports more devices,
“out of the box”, than any other
operating system ever has.**



Linux supports more different processors than any other operating system ever has.



The kernel has no obvious design.

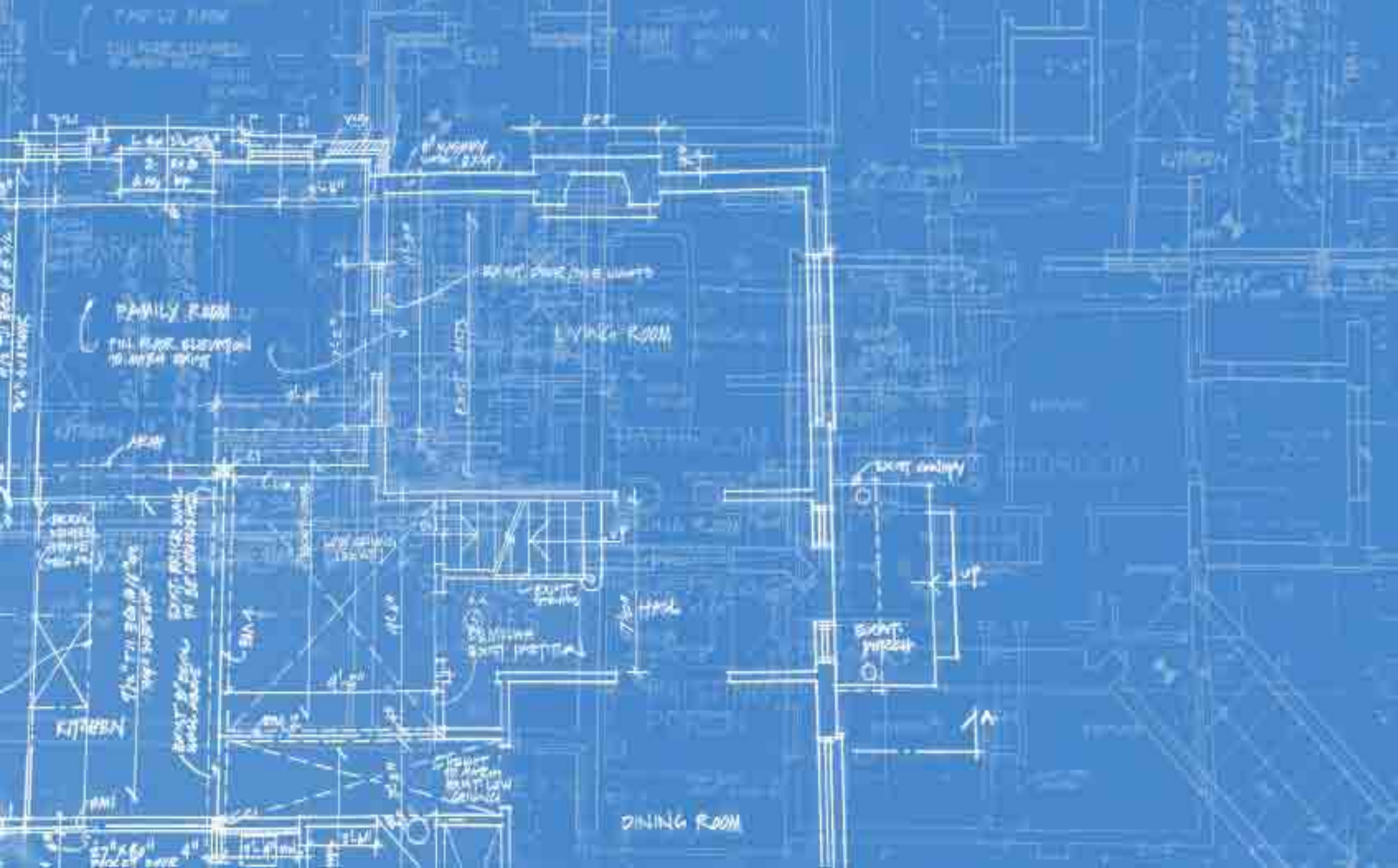

**“Open-source development
violates almost all known
management theories.”**

Dr. Marietta Baba,
Dean of the College of Social Science,
Michigan State University

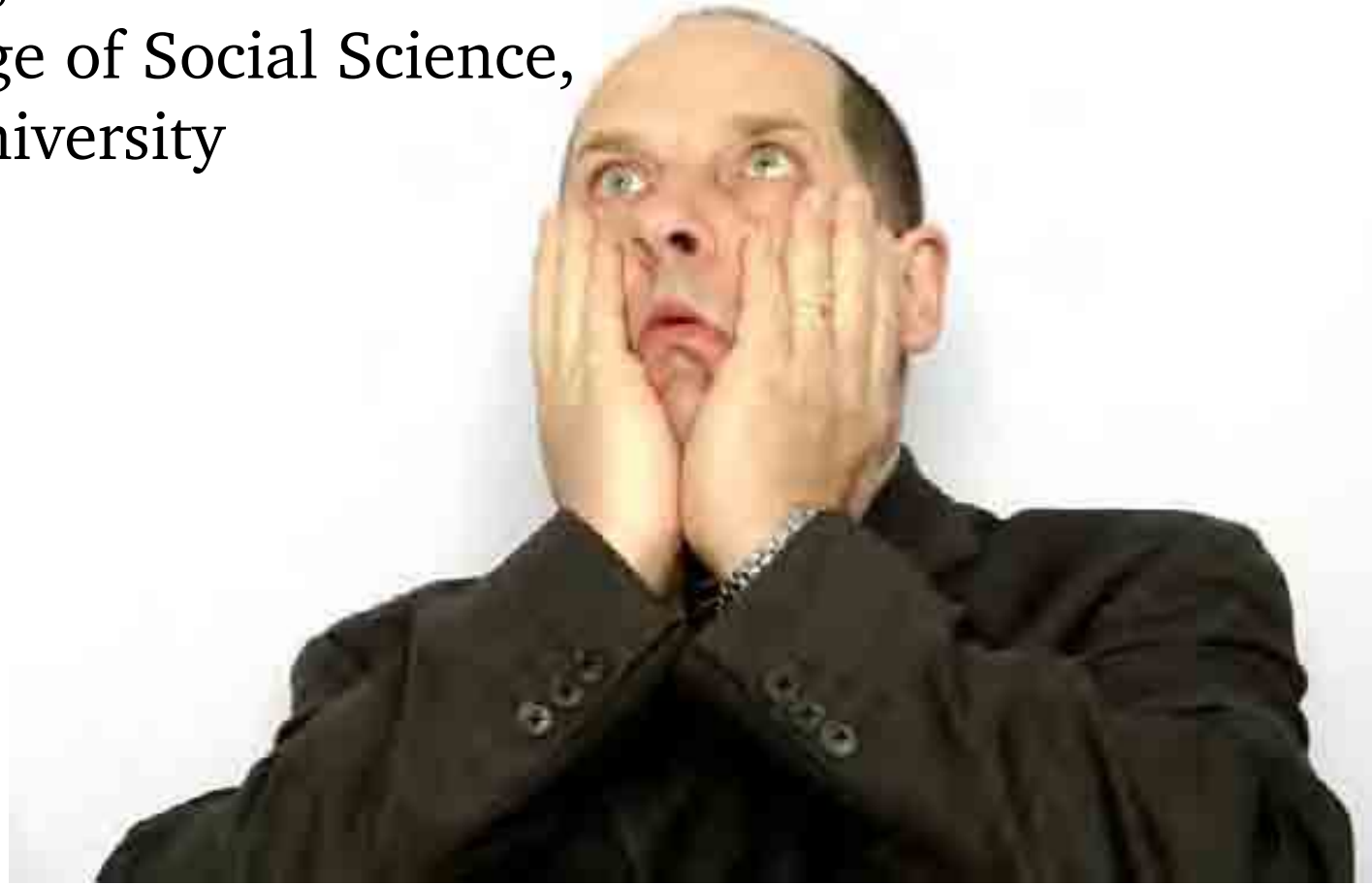

“Linux is evolution,



not intelligent design.”

- Linus Torvalds

“The kernel needs a stable API

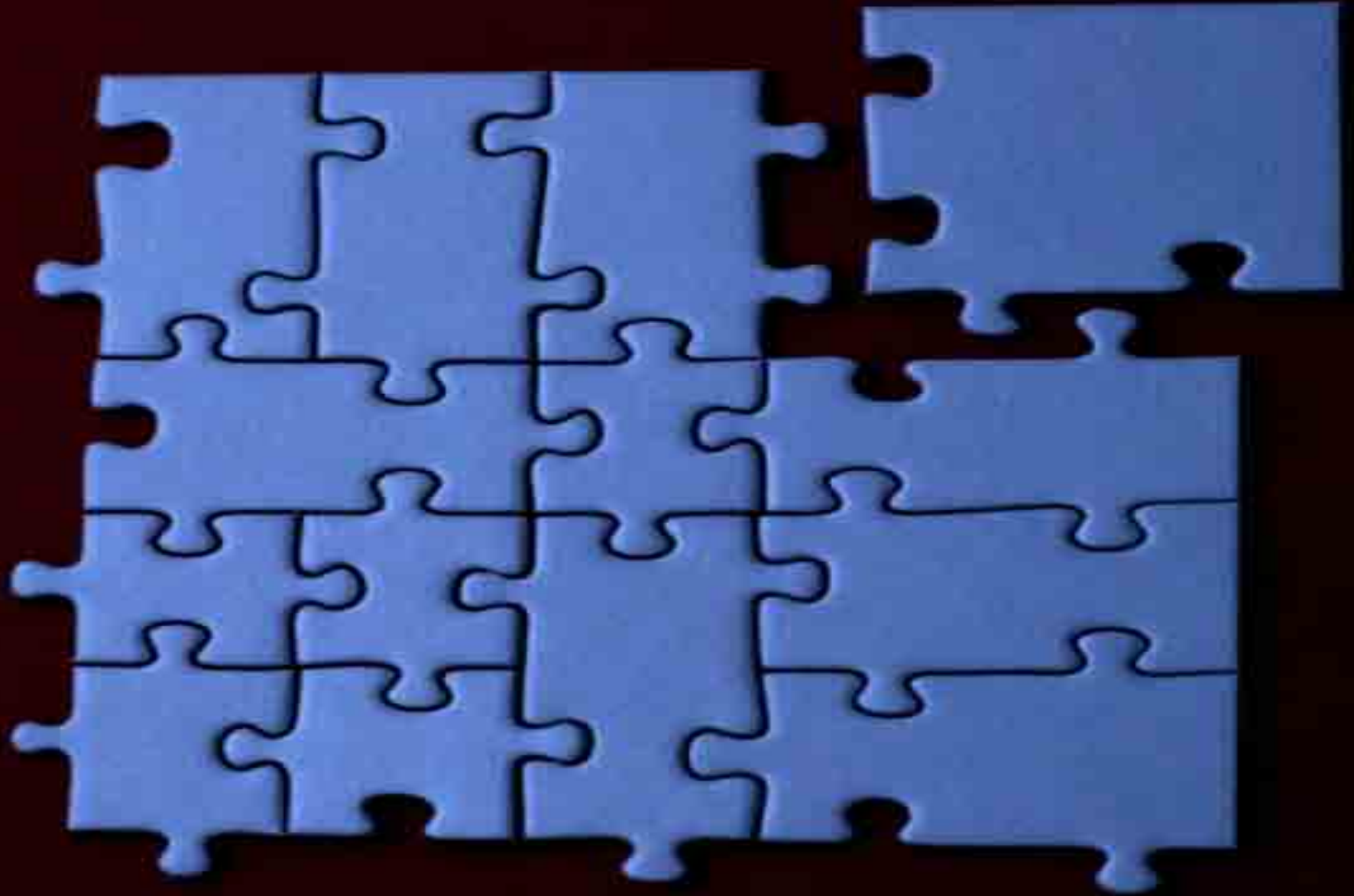

so vendors will write drivers.”

Documentation/

stable_api_nonsense.txt

“My driver is only for an obscure piece of hardware, it would never be accepted into the main kernel.”



**Closed source Linux
kernel modules
are illegal.**

**Closed source Linux
kernel modules
are unworkable.**

**Closed source Linux
kernel modules
are unethical.**



Novell's official position

Most developers of the kernel community consider non-GPL kernel modules to be infringing on their copyright. Novell does respect this position, and will no longer distribute non-GPL kernel modules as part of future products.

February 9, 2006

**It is hard to get code into
the main kernel tree.**



Documentation/HowTo

Kernel Newbies



Kernel Janitors





**Linux
kernel
mailing
list**

“Wow, for such a small file, every single function was incorrect. And you abused sysfs in a new and interesting way that I didn't think was even possible. I think this is two new records you have set here, congratulations.”

**- Greg Kroah-Hartman
lkml, May 2006**



“If only the kernel had a regression testsuite, everything would be better.”



bugzilla.kernel.org



**Linux supports more devices
than anyone else.**



Linux is evolution, not design.

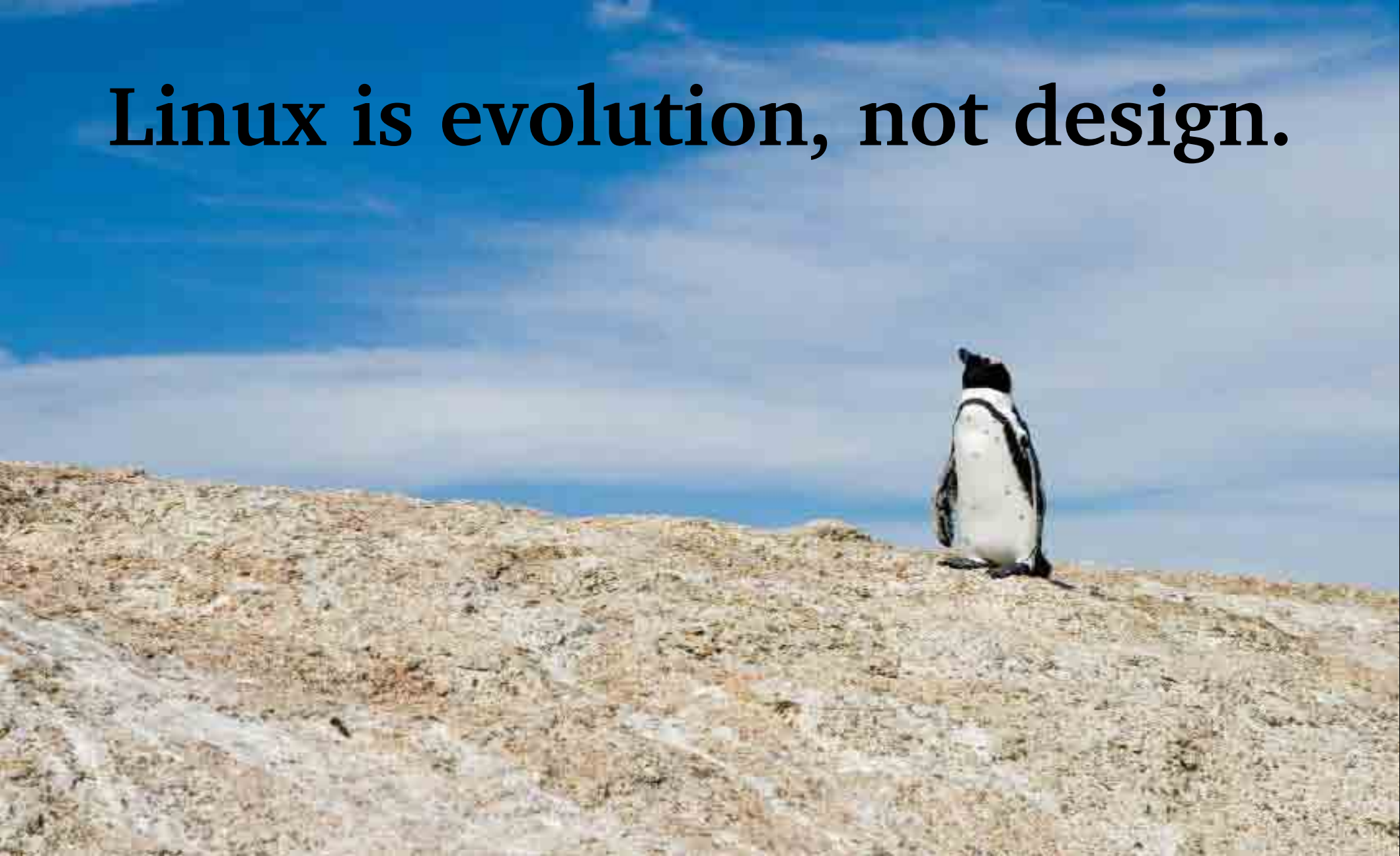

**Closed source modules
are illegal.**



Documentation/HOWTO



**We need help with review
and testing.**



**Total world domination is
proceeding as planned.**

